



# VIVOTEK Mounting Accessories

## AM-713 Junction Box

### Installation Guide

#### Revision History:

- Rev. 1.0: Initial release
- Rev. 1.1: Added info. for EPoC application.
- Rev. 1.2: Added surge protection connection.

Part no.: 625031302G  
Accessory Ordering part no.: 100138700G, AM-713\_V01  
EPoC junction box part no.: 100201400G

#### Compatible VIVOTEK Cameras

##### Compatible cameras/brackets

FD836B-HTV, FD836B-EHTV, FD836B-HVF2, FD836B-EHV2, FD8382-TV, FD8382-ETV, FD8382-VF2, FD8382-EVF2, FD9381-HTV, FD9381-EHTV, FD9371-HTV, FD9371-EHTV

#### Mounting Dimensions

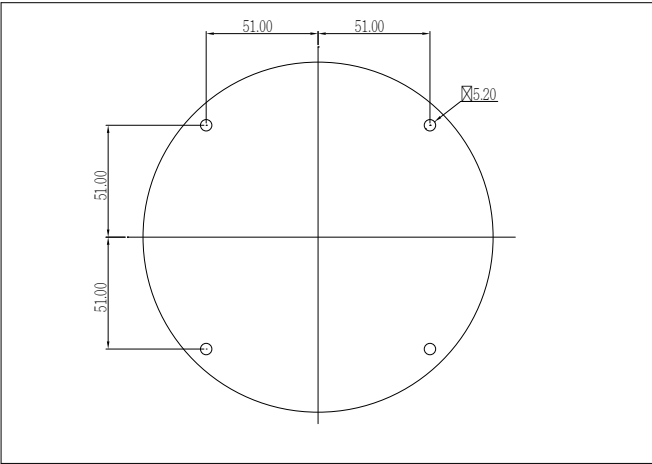

#### Package Contents

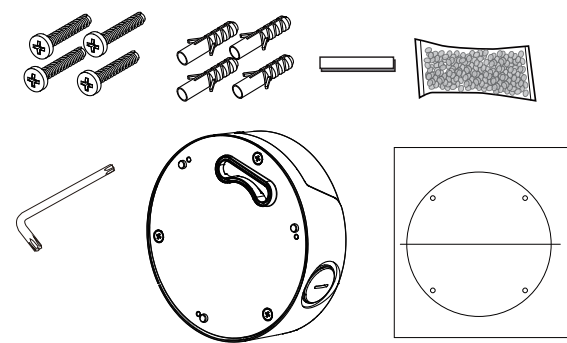

Remove the dome cover and waterproof connectors.

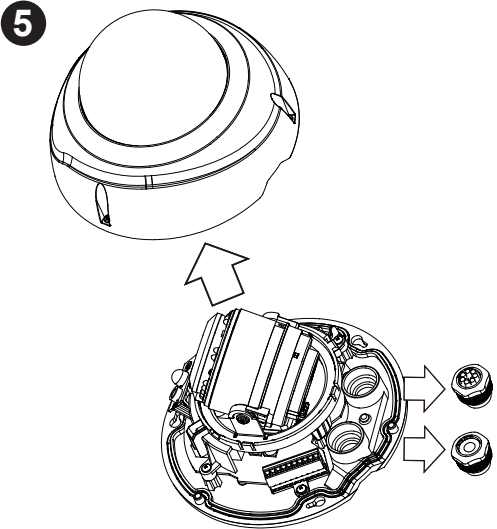

Pass cables through the center hole on the top cover. Secure the top cover by driving screws.

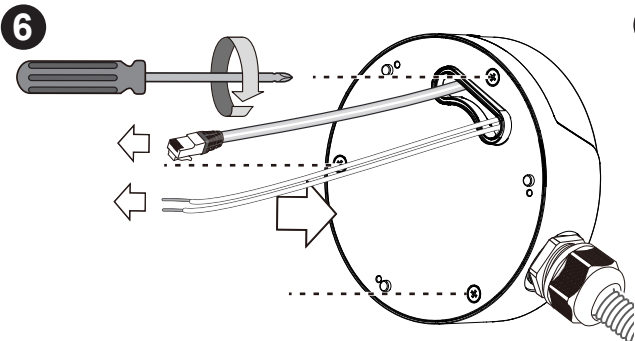

Pass cables through the routing holes and install the camera to box by driving screws.

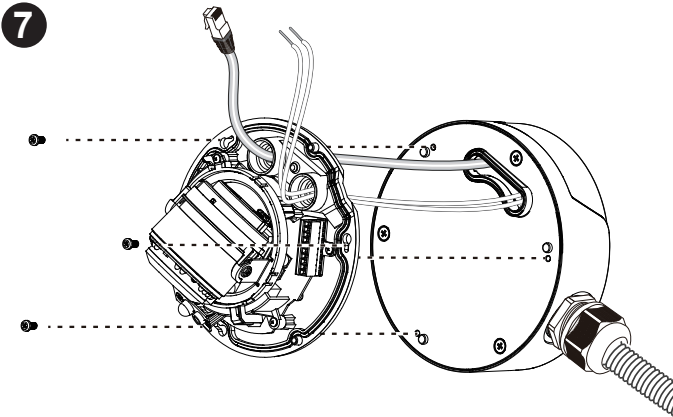

Connect cables to the Ethernet port and terminal block.

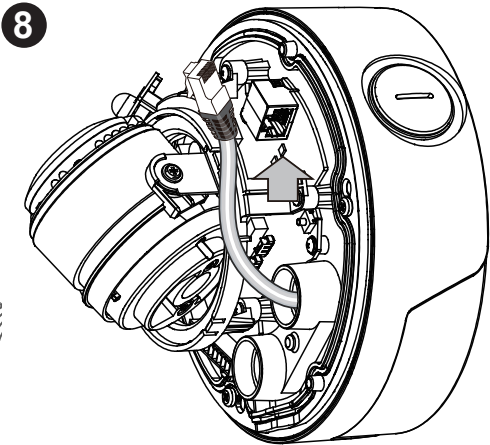

#### Installation

Remove the top cover and unhook the tether wire.

NOTE: If you have a PoE extender or EPoC device, install them now. Refer to the later section for details.

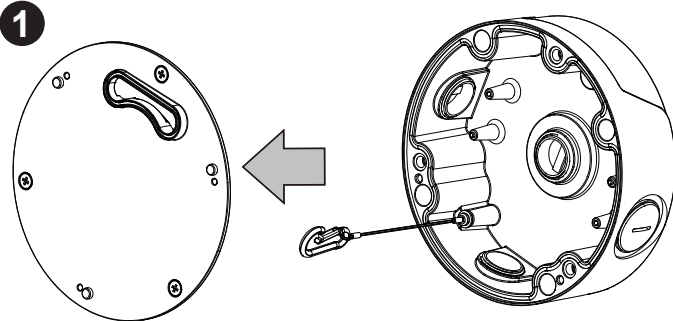

A 3/4" conduit is required for routing the cables with waterproof connection.

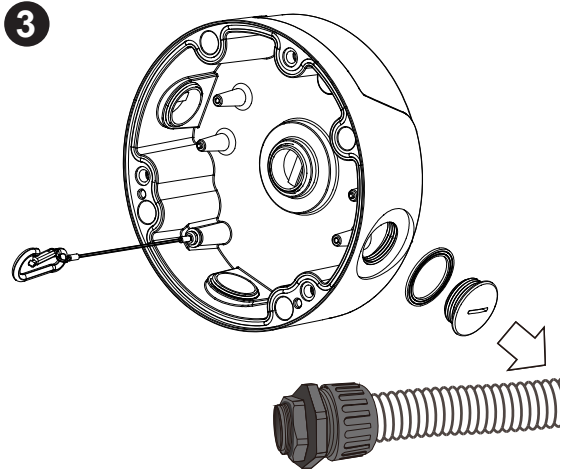

Install the cable gland and pass cables through it.

Attach the included alignment sticker to a preferred position. Drill holes on the wall and install the junction box. If space behind the wall allows, you may also pass cables through the wall.

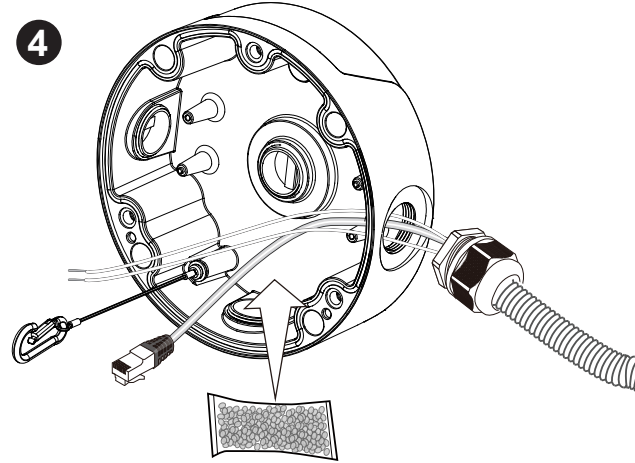
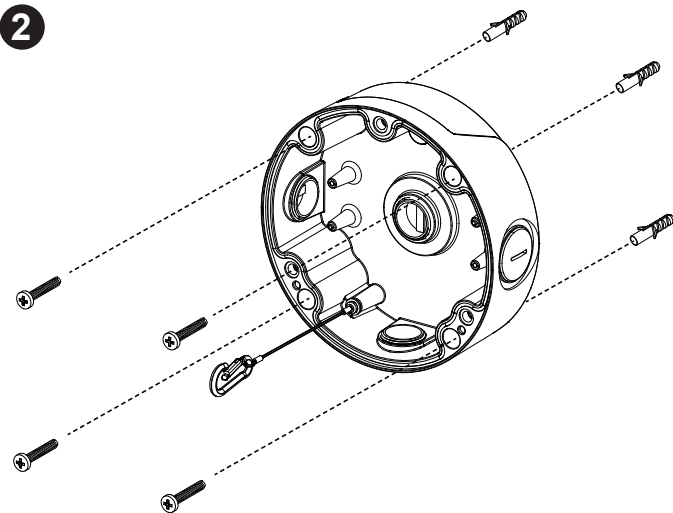

Attach a desiccant bag to the inside of the box. Note that the installation should be completed within 30 minutes so that desiccant remains effective.

Open a live view console and adjust the shooting direction. Refer to the camera's QIG for more information.

Secure the camera top cover.

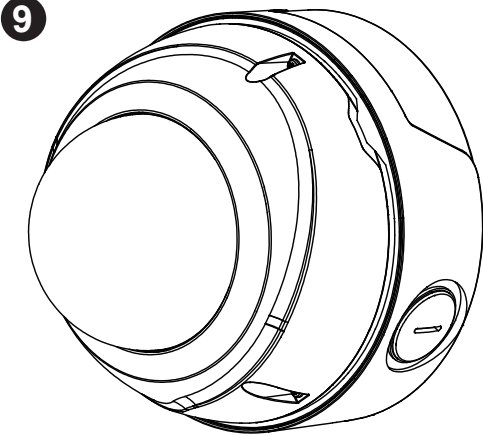

#### Optional Installation-1

You can also install a PoE extender (AP-FXC-0200) to the box.

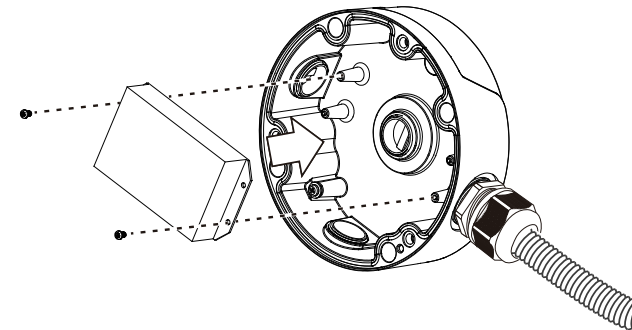

Connect the PoE IN and PoE OUT cables.

Put tags on the cables marking their intended use.

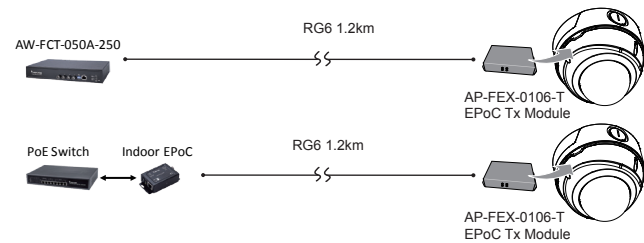
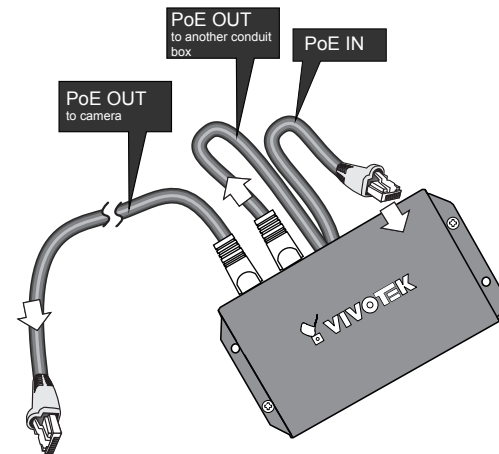

Surge Protection

Connect a ground wire to a surge protection device using the grounding hole on the EPoC Tx module so that the device is protected.

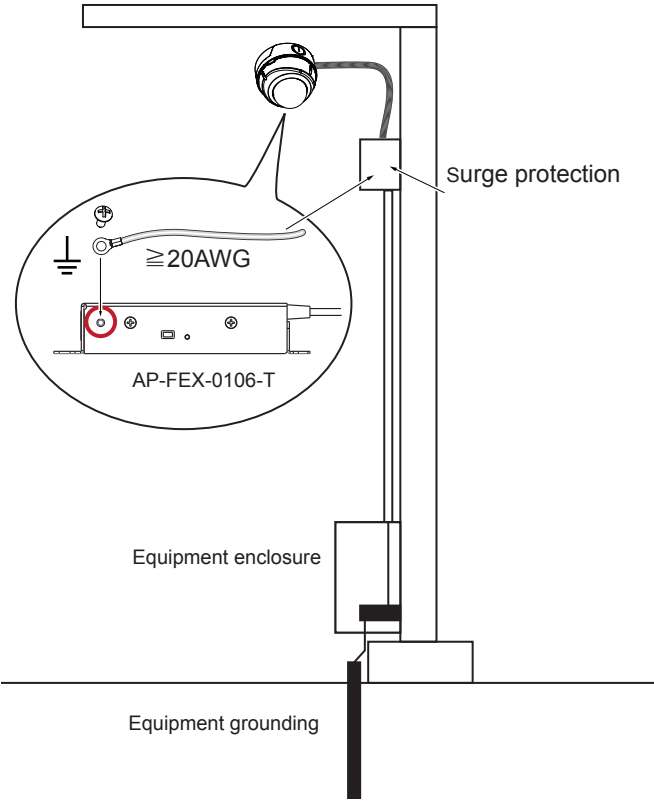

Optional Installation-2

You can also install an EPoC Tx module (AP-FEX-0106-T) to the box.

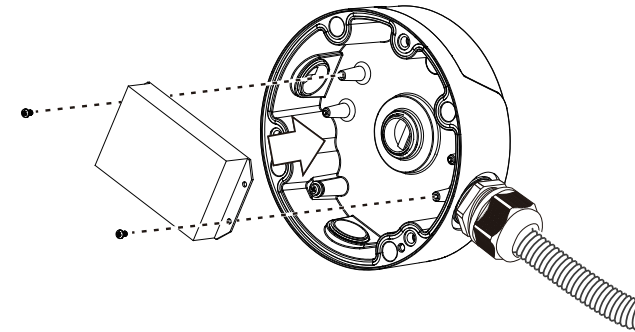

Connect the PoE OUT cable to the camera.

Connect an RG6 coaxial cable to the BNC connector on the module.

